

links series



LITHIUM GOLF LINKS SERIES

AUSTRALIA'S STRONG GOLF CART BATTERIES



RELIABLY BUILT
FOR ANY GAME OR DUTY

CHOOSING LITHIUM IS FUTURE PROOFING YOUR GOLF CART

Lithium Golf Links Series



Available in 51.2V outputs, the Links Series parallel kits is DROP-IN-READY lithium battery. Choose from several combinations of lithium batteries, to suit your needs, for maximum range. Each battery has Bluetooth. Simply remove the lead-acid batteries and replace with the Lithium Golf Links Series Batteries, attach cables in parallel, secure holding bracket, and the install is complete.

THE FUTURE IS NOW
SO WHY NOT EXPERIENCE IT?



BENEFITS

- Fast AND efficient charging.
 - Super light weight.
 - Low maintenance design - no constant watering or acidic mess.
 - Cost Saving - will more than halve# your maintenance cost.
 - Smart Battery Management - BMS includes thermal protections, short circuit, safeguards.
 - Upgradeable – it' s allows to add one more parallel into current kits after years later.
 - Bluetooth technology and a user-friendly mobile app
-

CATALOGUE

① Battery Data Model-SKU#: 0093 51.2V 27Ah	1
② Lithium Golf Brand Gauge	2
③ App Operation Instruction	3-4
④ Parallel system installation & instruction	5-6
⑤ Warranty Policy	7-9





SKU#: 0093

Voltage: 51.2V Capacity: 27Ah Energy: 1382.4Wh

51.2V

27Ah



ELECTRICAL SPECIFICATIONS

Nominal Voltage	51.2V
Nominal Capacity	27Ah
Bluetooth Enabled	YES
Capacity @ 20A	81 min
Efficiency	99%
Self Discharge	1-3% per month

DISCHARGE SPECIFICATIONS

Max Continuous Current	50A
Peak Discharge Current	150A (5s)
Low Voltage Disconnect	40V
BMS Discharge Voltage Cut-Off	40.0V (2.5±0.05 vpc)
Reconnect Voltage	44.8V (2.8±0.1 vpc)
Short Circuit Protection	200-400ms

CHARGE SPECIFICATIONS

Recommended Charge Current	15A - 30A
Discharge Temperature	0°C to 50°C
Temperature Protection Release	/
Charge Temperature*	/
Recommended Charge Voltage	43V - 58.3V
BMS Charge Voltage Cut-Off	58.3V (3.65±0.01vpc)
Reconnect Voltage	56V (3.5±0.01vpc)

MECHANICAL SPECIFICATIONS

Battery Dimensions (L × W × H mm)	260 × 180 × 242
Battery Net Weight	15kgs
Package Dimensions (L × W × H mm)	290 × 215 × 310
Gross Weight	15.5kgs
Terminal Type	M8
Terminal Material	Brass
Case Material	Steel
Enclosure Protection	IP54
Cell Type - Chemistry	Prismatic LiFePO4

KEY FEATURES

BMS languages - CANbus & RS485
 Sleep Mode
 Fire Arrestor
 Gauge mode: 0102
 Blue Tooth available: Yes

PRODUCT PICTURE





LITHIUM GOLF BRAND GAUGE



Lithium Golf Brand Gauge
SKU: 10011-0102



Lithium Golf Brand Gauge
SKU: 10011-0076



Lithium Golf Brand Gauge
SKU: 10011-0091

WAEN CODE	WARN TRIGGERL	LEVEL	DESCRIPTION
1	One Cell Over Voltage	3	This warning will display when one cell is over 3.65V. If one cell reaches 3.65V, this is part of normal operation and the BMs will shut down. When the SOC shows 100% , the warning will disappear. This warning will not happen during charge if updating gauge firmware to V2.08
2	One Cell Low Voltage	1	This warning will display when one cell is lower than 2500mv
3	Battery Voltage is too high	2	This warning will display when battery volts is over 58.4V
4	Battery Voltage is too low	2	This warning will display when battery volts is lower than 40V.
5	Cell Voltage Variation too high within cells	1	This warning will display when cell difference is over 500m
6	Over Current Drain	3	This warning will display when the current drain is more than500A
7	Over Current Charging	3	This warning will display when charging current is more than200A
8	Battery Temperature is too high	1	This warning will display when the battery temperature is higher than 75° C
9	Battery Temperature is too low	1	This warning will display when the battery temperature is lower than -10° C
10	Battery Temperature variation too high between the collectors	2	This warning will display when the temperature difference is higher than 12° C
11	SOC is too low	3	This warning will display when the SOC is lower than 15%

Warning Level 1: RED, please report the warning to seller or Lithium Golf Australia 1300918888 or info@ligolf.com.au

Warning Level 2: YELLOW, please report the warning or observe until warning disappears.

Warning Level 3: BLUE, please observe until warning disappears.



APP OPERATION INSTRUCTION

Battery name searching box. Batteries will be filtered by keywords.

Automatically detects Bluetooth device permissions and locate the authorization. If it is not turned on, it will prompt the customer and jump to the appropriate page to turn on the authorization

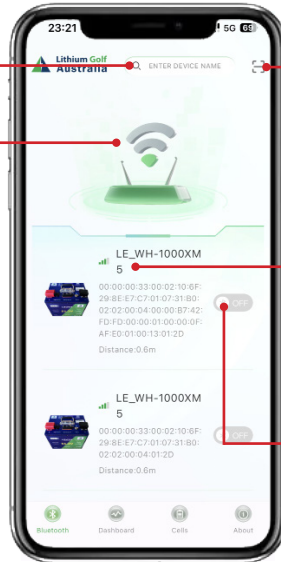

Automatically connect batteries by scanning QR code (only for batteries whose mac address matches QR code)

Batteries are sorted by signal strength and distance from near to far, in descending order.

After the battery is currently connected, every time the battery is turned on, it will automatically connect to the previously connected battery. This function is disabled when manually disconnected.

SOC

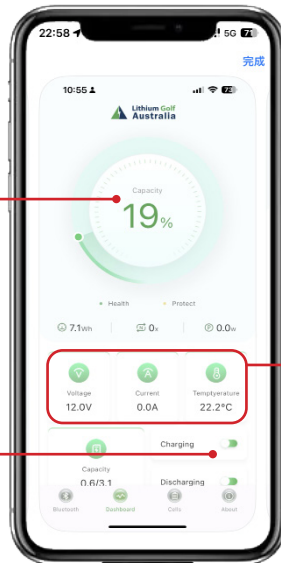

All data of the dial. If protection occurs abnormally, the green light will turn to light yellow. For example, if the current is protected, it will light up on the module of current. If the voltage is over-voltage/under-voltage, it will light up at the corresponding position.

Charge/discharge mos tube Switch

Status of the whole battery
Maximum voltage.
Minimum voltage
Voltage difference

If battery protection
or failure occurs, it will
change from green color
to light yellow color

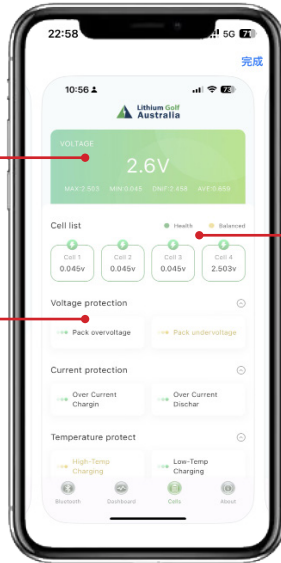

The specific data of the
cells will dynamically
recognize the number
of battery strings. When
the cells are equalized,
the corresponding cells
will turn yellowish color

Battery History

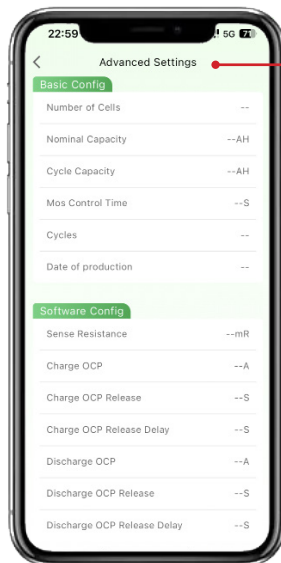
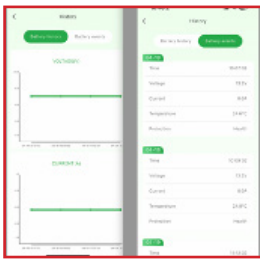

Advanced Settings
Page. Click to set the
appropriate parameters.
Non-professionals are
advised to use with
caution. (Password
999000 for after-
sales use only. Public
disclosure is prohibited)

● App Download





Links Series

1. How to choose Lithium Golf Links Series Parallel kits?

- If it's a normal motor 2 passengers golf cart for golf only, and play one round 18 holes or 2 rounds 18 holes every week, 2 parallels are suggested.
- If it's a big motor golf cart or play golf above 2 rounds 18 holes very week, 3 parallels or above 3 are suggested.
- For all commercial users, 3 parallels or above 3 parallels for premium parallel system or other Amplus system products are provided.

2. How to install Lithium Golf Links series battery kits?

- Please ensure to use parallel connection. If connected in series connection, the vehicle may be destroyed.
- Please keep all batteries in similar resistance when the batteries are in charging or discharging.
- 2 parallels, 3 parallels, 4 parallels and 5 parallels installation solution are listed below. If it's different kits, please follow above two installation rules or inquire authorized dealers or manufactory.

▼ 2 Parallels Installation

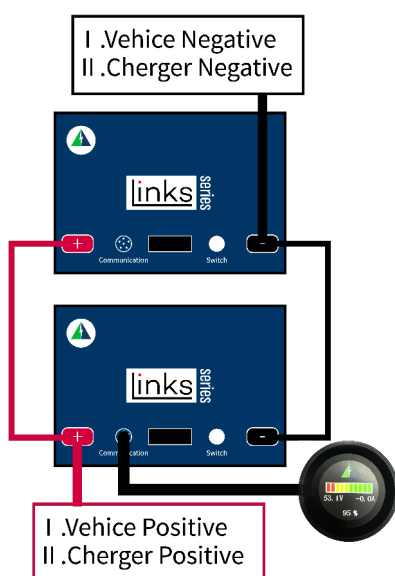

▼ 3 Parallels Installation

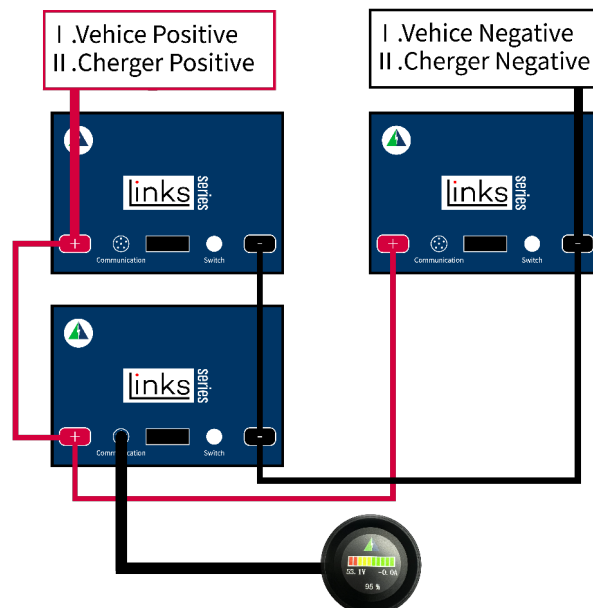

▼ 4 Parallels Installation

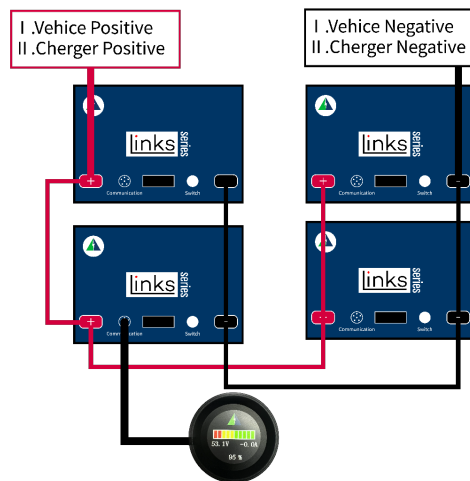

▼ 5 Parallels Installation

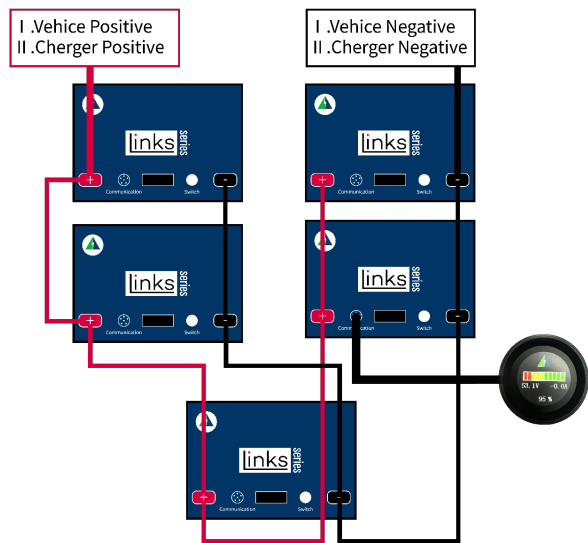

3. How to use it after installation?

- Please charge batteries full after installation.
- **PLEASE DO NOT UNPLUG CHARGER FROM GOLF CART SIDE DIRECTLY WHEN CHARGER IS WORKING. IF HAVE TO STOP CHARGING, PLEASE UNPLUG THE WALL FIRSTLY, AND THEN UNPLUG THE GOLF CART PLUG.**
- Please take off charger plug from golf cart for 1 minutes and plug in again to restart to charge batteries one day before use it. Some golf cart can drain batteries even with switch off. The charger will not in automatic charging after charged full the batteries.
- If the gauge shows under 49.8V, please stop to use the cart and charge the batteries immediately.
- **PLEASE ENSURE THE TERMINAL IS PROPERLY TIGHT IN EACH 6 MONTHS.**
- If 2 parallel system for golf fails to play one round 18 holes, use below solution to check the kits firstly:

Step 1: Please charger the battery kits to full.

Step 2: Please disconnect the parallel batteries, keep each battery separately.

Step 3: Please use multimeter to measure each battery voltages, if all are above 49v, please connect each single battery to the cart and charge them full, and then parallel connect them again. If the problem still exist, please contact the dealer where you bought or contact Lithium Golf directly with 1800918888 or info@ligolf.com.au.



WARRANTY

Lithium Golf LiFePO₄ Battery Pack Only

Lithium Golf PTY LTD (“Manufacturer”) warranty each Lithium Golf LiFePO₄ Golf Pack (“Product”) consisting of Lithium Golf branded components; LiFePO₄ Battery/Batteries, LiFePO₄ Battery Charger and LiFePO₄ Battery Meter sold by Authorised Dealers in Australia to be free of defects in material and workmanship for a period (the Warranty Period”) based upon the Product use application, , after the date of purchase, as evidenced by the original receipt (the “Warranty Period”). Batteries must be registered within 30 days of purchase to activate the warranty if purchase the battery after 01-03-2024. Batteries must be registered before 01-10-2024 if purchased battery before 01-03-2024.

1. WARRANTY PERIOD

Private Golf Use — 5 YEARS for Private Golf customers, using the Product for their own Personal golfing.

Commercial and Non-Golf Use — 3 YEARS for Commercial and Non-Golf customers using the Product for Commercial or purposes outside of Golf. This includes using the Product as part of Business Operations, including renting Golf Carts to customers, using the vehicle for a purpose other than Golf, including as transport on private or public areas.

2. NON-TRANSFERABLE

This Warranty applies only to the original end-user/owner of the Product and is not transferable to any other person or entity.

3. WARRANTY EXCLUSIONS

Manufacturer provides Warranty on Products only and will not be held responsible for any damage to the Product or vehicle as a result of incorrect installation, abuse or neglect. Examples include but are not limited to:

- Using components that have not been approved by the Manufacturer as replacement components to those which are supplied in the Manufacturer’s original Product pack
- Failure to correctly install the Product or Charger
- Failure to properly store the Product. This includes not disconnecting Product from any items that may draw power
- Damage due to over-tightening and stripping of terminals
- Damage caused during shipping or mishandling of the Product
- Using the Product for any purpose outside it’s intended design
- Incorrect Product size or capacity for the application, for example, insufficient Amp Hours for intended application, the battery kits that has been used more than 80% depth of discharge repeatedly within 24-hour periods etc.
- Incorrect voltage applied to application
- Products that have had the serial number or manufacturing date codes removed or tampered with
- Breakage, freezing, wreckage, water damage, melted and broken terminals
- Damage due to improper installation; loose terminal connections, under-sized ca-

bling, incorrect connections (series and parallel) for desired voltage and AH requirements, installing in reverse polarity

- Environmental damage; inappropriate storage conditions as defined by the Manufacturer; exposure to extreme hot or cold temperatures
- Product that has been opened, modified or tampered with
- Using discharge/test machines.
- Product damage caused by faulty Golf Cart systems or components, including, but not limited to; motor, computer, controller, solenoid, other items not provided by the Manufacturer's original Product pack
- As per Australian Consumer Law (ACL), the Manufacturer will not be responsible or liable for any consequential or incidental expense or loss if the battery usage is not for Private Use (personal, domestic or household use). This warranty is in addition to any consumer guarantees covered by the ACL.

4. HOW TO MAKE A CLAIM

Warranty claims are to be made only by an Authorised Dealer or the end-user/owner of the Product. When submitting a Warranty claim the customer may be required to provide relevant information to support the Warranty claim, including but not limited to:

- Original receipt for purchase
- Photos or video evidence of the failure
- Returning Product to Authorised Dealer or Manufacturer.

All requests must start by either contacting the Authorised Dealer from where Product was purchased or by filling out a Technical Support Request (TSR) which can be found under support link on the Manufacturer's website. The TSR will be reviewed and responded to with the necessary technical assistance.

If technical assistance does not resolve the issue and the claim is seemingly covered under warranty, the Manufacturer will send approval for the product be sent to the Manufacturer at the expense of the end-user/owner of the Product. Every box must include the ""Approval to Send letter"", a copy of the TSR and the original proof of purchase. If this is not included the item will be returned to sender.

The Manufacturer will test the Product and determine if the product was affected by the above defects or damage to the Product arising from any abuse or mishandling of the Product. See list of noncovered conditions located above (3. Warranty Exclusions). Warranties are for repair, replacement, or substitution only, in Manufacturer's sole discretion. Refunds are not available.

5. WARRANTY DISCLAIMER

In the event buyer's Battery(ies) needs to be returned to Lithium Golf Pty Ltd for any reason included warranty evaluation, the cost of shipping and packaging to send the Battery(ies) to Lithium Golf Pty Ltd shall be the sole responsibility of the buyer. Any Battery(ies) deemed defective in material or workmanship shall, subject to buyer's election to have it repaired or replaced and buyer's payment of any amounts owed to Lithium Golf Pty Ltd as provided above, be repaired, or replaced, and returned to the buyer with Lithium Golf Pty Ltd paying the cost of shipping. Lithium Golf Pty Ltd recommends buyer fully insure any return shipment in case of loss or damage in transit. Buyer shall use a carrier that can provide buyer with tracking numbers and proof of delivery. If buyer needs assistance with shipping Battery(ies) to Lithium Golf Pty Ltd for warranty evaluation, Lithium Golf Pty Ltd may require a deposit of AU\$250 to cover the cost of return shipping and diagnosis. Any shipment which arrives damaged or without a Technical Support Request (TSR) will be refused or held at the warehouse until buyer pays

for return shipping or files an insurance claim.

6. WARRANTY DISCLAIMER

This warranty is in lieu of, and Manufacturer disclaims and excludes, all other express warranties. Manufacturer further limits the duration of all, whether statutory, express or implied warranties, including, without limitation, any warranty of merchantability or fitness for a particular purpose, to the Warranty Period.

Manufacturer's exclusive liability for breach of any warranty on the Product shall be to replace the Product within the Warranty Period in accordance with the terms of this warranty. In no event shall the Manufacturer be liable for any loss or damages of any other kind, whether direct, incidental, and consequential including lost profits, labor cost, exemplary, special or otherwise, including any lost profits or removal, shipping, labor cost, or installation expenses.

EXCEPT FOR THE WARRANTY SET FORTH ABOVE, SELLER MAKES NO WARRANTY WHATSOEVER WITH RESPECT TO THE GOODS, INCLUDING ANY (A) WARRANTY OF MERCHANTABILITY; OR (B) WARRANTY OF FITNESS FOR A PARTICULAR PURPOSE; WHETHER EXPRESS OR IMPLIED BY LAW, COURSE OF DEALING, COURSE OF PERFORMANCE, USAGE OF TRADE OR OTHERWISE.

MANUFACTURER

Lithium Golf - 33B Bonview Cct, Truganina, Victoria 3029

www.ligolf.com.au

www.ligolf.com.au info@ligolf.com.au

1800 91 8888



WARRANTY REGISTRATION

Full Name

Address

Place of purchase

E-mail

Phone Numeber

Purchase Date

Series No.

Make/Model/Year of Vehicle



Intended Use Golf Comerical Non-Golf

How many full rounds(18 holes)weekly

Charging Habits

- Charged full after use it
- Charged full when SOC low than 50%
- Charged full when SOC low than 20%



BATTERY MAINTENANCE LOG

Maintenance Requirements

For Personal golf, please maintenance annual at least
For all other application, please maintenance each 6 months at least

Customer _____

Address _____

Date Purchased _____

Controller Type _____

Time of Service Start: _____

End: _____

Distributor Name _____

Service Engineer _____

Battery Model _____

Battery SN. _____

● BATTERY CELL LOG

The cells information can be found on Lithium Golf gauge or blue tooth app, please record the cell information after 2 hours later charged the battery full

Cell NO.	Cell Voltage	Cell NO.	Cell Voltage	Cell NO.	Cell Voltage
1		9		17	
2		10		18	
3		11		19	
4		12		20	
5		13		21	
6		14		22	
7		15		23	
8		16		24	

Battery Volts: _____

● BATTERY CHECKLIST

YES NO Battery Tops Clean and Dry Comments: _____

YES NO Ensure Vent Caps are Clean Comments: _____

YES NO Battery Terminal Connections Tight Comments: _____

YES NO Battery temperature in normal range when charging the battery Comments: _____

Others: _____

● LITHIUM GOLF CHARGER

Charger Plug Pin stable and clean YES NO Comments: _____

Charger temperature in normal range when charging the battery YES NO Comments: _____

Signed by Service Engineer _____

Signed by Customer _____

Additional remarks _____

BATTERY MAINTENANCE LOG

Maintenance Requirements

For Personal golf, please maintenance annual at least
For all other application, please maintenance each 6 months at least

Customer _____

Address _____

Date Purchased _____

Controller Type _____

Time of Service

Start: _____

End: _____

Distributor Name _____

Service Engineer _____

Battery Model _____

Battery SN. _____

● BATTERY CELL LOG

The cells information can be found on Lithium Golf gauge or blue tooth app, please record the cell information after 2 hours later charged the battery full

Cell NO.	Cell Voltage	Cell NO.	Cell Voltage	Cell NO.	Cell Voltage
1		9		17	
2		10		18	
3		11		19	
4		12		20	
5		13		21	
6		14		22	
7		15		23	
8		16		24	

Battery Volts: _____

● BATTERY CHECKLIST

YES NO

Battery Tops Clean and Dry

Comments: _____

YES NO

Ensure Vent Caps are Clean

Comments: _____

YES NO

Battery Terminal Connections Tight

Comments: _____

YES NO

Battery temperature in normal range when charging the battery

Comments: _____

Others: _____

● LITHIUM GOLF CHARGER

Charger Plug Pin stable and clean

YES NO

Comments: _____

Charger temperature in normal range when charging the battery

YES NO

Comments: _____

Signed by Service Engineer _____

Signed by Customer _____

Additional remarks _____

BATTERY MAINTENANCE LOG

Maintenance Requirements

For Personal golf, please maintenance annual at least
For all other application, please maintenance each 6 months at least

Customer _____

Address _____

Date Purchased _____

Controller Type _____

Time of Service Start: _____

End: _____

Distributor Name _____

Service Engineer _____

Battery Model _____

Battery SN. _____

● BATTERY CELL LOG

The cells information can be found on Lithium Golf gauge or blue tooth app, please record the cell information after 2 hours later charged the battery full

Cell NO.	Cell Voltage	Cell NO.	Cell Voltage	Cell NO.	Cell Voltage
1		9		17	
2		10		18	
3		11		19	
4		12		20	
5		13		21	
6		14		22	
7		15		23	
8		16		24	

Battery Volts: _____

● BATTERY CHECKLIST

YES NO Battery Tops Clean and Dry Comments: _____

YES NO Ensure Vent Caps are Clean Comments: _____

YES NO Battery Terminal Connections Tight Comments: _____

YES NO Battery temperature in normal range when charging the battery Comments: _____

Others: _____

● LITHIUM GOLF CHARGER

Charger Plug Pin stable and clean YES NO Comments: _____

Charger temperature in normal range when charging the battery YES NO Comments: _____

Signed by Service Engineer _____

Signed by Customer _____

Additional remarks _____

BATTERY MAINTENANCE LOG

Maintenance Requirements

For Personal golf, please maintenance annual at least
For all other application, please maintenance each 6 months at least

Customer _____

Address _____

Date Purchased _____

Controller Type _____

Time of Service

Start: _____

End: _____

Distributor Name _____

Service Engineer _____

Battery Model _____

Battery SN. _____

● BATTERY CELL LOG

The cells information can be found on Lithium Golf gauge or blue tooth app, please record the cell information after 2 hours later charged the battery full

Cell NO.	Cell Voltage	Cell NO.	Cell Voltage	Cell NO.	Cell Voltage
1		9		17	
2		10		18	
3		11		19	
4		12		20	
5		13		21	
6		14		22	
7		15		23	
8		16		24	

Battery Volts: _____

● BATTERY CHECKLIST

YES NO

Battery Tops Clean and Dry

Comments: _____

YES NO

Ensure Vent Caps are Clean

Comments: _____

YES NO

Battery Terminal Connections Tight

Comments: _____

YES NO

Battery temperature in normal range when charging the battery

Comments: _____

Others: _____

● LITHIUM GOLF CHARGER

Charger Plug Pin stable and clean

YES NO

Comments: _____

Charger temperature in normal range when charging the battery

YES NO

Comments: _____

Signed by Service Engineer _____

Signed by Customer _____

Additional remarks _____

BATTERY MAINTENANCE LOG

Maintenance Requirements

For Personal golf, please maintenance annual at least
For all other application, please maintenance each 6 months at least

Customer _____

Address _____

Date Purchased _____

Controller Type _____

Time of Service Start: _____

End: _____

Distributor Name _____

Service Engineer _____

Battery Model _____

Battery SN. _____

● BATTERY CELL LOG

The cells information can be found on Lithium Golf gauge or blue tooth app, please record the cell information after 2 hours later charged the battery full

Cell NO.	Cell Voltage	Cell NO.	Cell Voltage	Cell NO.	Cell Voltage
1		9		17	
2		10		18	
3		11		19	
4		12		20	
5		13		21	
6		14		22	
7		15		23	
8		16		24	

Battery Volts: _____

● BATTERY CHECKLIST

YES NO Battery Tops Clean and Dry Comments: _____

YES NO Ensure Vent Caps are Clean Comments: _____

YES NO Battery Terminal Connections Tight Comments: _____

YES NO Battery temperature in normal range when charging the battery Comments: _____

Others: _____

● LITHIUM GOLF CHARGER

Charger Plug Pin stable and clean YES NO Comments: _____

Charger temperature in normal range when charging the battery YES NO Comments: _____

Signed by Service Engineer _____

Signed by Customer _____

Additional remarks _____

BATTERY MAINTENANCE LOG

Maintenance Requirements

For Personal golf, please maintenance annual at least
For all other application, please maintenance each 6 months at least

Customer _____

Address _____

Date Purchased _____

Controller Type _____

Time of Service Start: _____

End: _____

Distributor Name _____

Service Engineer _____

Battery Model _____

Battery SN. _____

● BATTERY CELL LOG

The cells information can be found on Lithium Golf gauge or blue tooth app, please record the cell information after 2 hours later charged the battery full

Cell NO.	Cell Voltage	Cell NO.	Cell Voltage	Cell NO.	Cell Voltage
1		9		17	
2		10		18	
3		11		19	
4		12		20	
5		13		21	
6		14		22	
7		15		23	
8		16		24	

Battery Volts: _____

● BATTERY CHECKLIST

YES NO Battery Tops Clean and Dry Comments: _____

YES NO Ensure Vent Caps are Clean Comments: _____

YES NO Battery Terminal Connections Tight Comments: _____

YES NO Battery temperature in normal range when charging the battery Comments: _____

Others: _____

● LITHIUM GOLF CHARGER

Charger Plug Pin stable and clean YES NO Comments: _____

Charger temperature in normal range when charging the battery YES NO Comments: _____

Signed by Service Engineer _____

Signed by Customer _____

Additional remarks _____

BATTERY MAINTENANCE LOG

Maintenance Requirements

For Personal golf, please maintenance annual at least
For all other application, please maintenance each 6 months at least

Customer _____

Address _____

Date Purchased _____

Controller Type _____

Time of Service Start: _____

End: _____

Distributor Name _____

Service Engineer _____

Battery Model _____

Battery SN. _____

● BATTERY CELL LOG

The cells information can be found on Lithium Golf gauge or blue tooth app, please record the cell information after 2 hours later charged the battery full

Cell NO.	Cell Voltage	Cell NO.	Cell Voltage	Cell NO.	Cell Voltage
1		9		17	
2		10		18	
3		11		19	
4		12		20	
5		13		21	
6		14		22	
7		15		23	
8		16		24	

Battery Volts: _____

● BATTERY CHECKLIST

YES NO Battery Tops Clean and Dry Comments: _____

YES NO Ensure Vent Caps are Clean Comments: _____

YES NO Battery Terminal Connections Tight Comments: _____

YES NO Battery temperature in normal range when charging the battery Comments: _____

Others: _____

● LITHIUM GOLF CHARGER

Charger Plug Pin stable and clean YES NO Comments: _____

Charger temperature in normal range when charging the battery YES NO Comments: _____

Signed by Service Engineer _____

Signed by Customer _____

Additional remarks _____

BATTERY MAINTENANCE LOG

Maintenance Requirements

For Personal golf, please maintenance annual at least
For all other application, please maintenance each 6 months at least

Customer _____

Address _____

Date Purchased _____

Controller Type _____

Time of Service Start: _____

End: _____

Distributor Name _____

Service Engineer _____

Battery Model _____

Battery SN. _____

● BATTERY CELL LOG

The cells information can be found on Lithium Golf gauge or blue tooth app, please record the cell information after 2 hours later charged the battery full

Cell NO.	Cell Voltage	Cell NO.	Cell Voltage	Cell NO.	Cell Voltage
1		9		17	
2		10		18	
3		11		19	
4		12		20	
5		13		21	
6		14		22	
7		15		23	
8		16		24	

Battery Volts: _____

● BATTERY CHECKLIST

YES NO Battery Tops Clean and Dry Comments: _____

YES NO Ensure Vent Caps are Clean Comments: _____

YES NO Battery Terminal Connections Tight Comments: _____

YES NO Battery temperature in normal range when charging the battery Comments: _____

Others: _____

● LITHIUM GOLF CHARGER

Charger Plug Pin stable and clean YES NO Comments: _____

Charger temperature in normal range when charging the battery YES NO Comments: _____

Signed by Service Engineer _____

Signed by Customer _____

Additional remarks _____

BATTERY MAINTENANCE LOG

Maintenance Requirements

For Personal golf, please maintenance annual at least
For all other application, please maintenance each 6 months at least

Customer _____

Address _____

Date Purchased _____

Controller Type _____

Time of Service Start: _____

End: _____

Distributor Name _____

Service Engineer _____

Battery Model _____

Battery SN. _____

● BATTERY CELL LOG

The cells information can be found on Lithium Golf gauge or blue tooth app, please record the cell information after 2 hours later charged the battery full

Cell NO.	Cell Voltage	Cell NO.	Cell Voltage	Cell NO.	Cell Voltage
1		9		17	
2		10		18	
3		11		19	
4		12		20	
5		13		21	
6		14		22	
7		15		23	
8		16		24	

Battery Volts: _____

● BATTERY CHECKLIST

YES NO Battery Tops Clean and Dry Comments: _____

YES NO Ensure Vent Caps are Clean Comments: _____

YES NO Battery Terminal Connections Tight Comments: _____

YES NO Battery temperature in normal range when charging the battery Comments: _____

Others: _____

● LITHIUM GOLF CHARGER

Charger Plug Pin stable and clean YES NO Comments: _____

Charger temperature in normal range when charging the battery YES NO Comments: _____

Signed by Service Engineer _____

Signed by Customer _____

Additional remarks _____

BATTERY MAINTENANCE LOG

Maintenance Requirements

For Personal golf, please maintenance annual at least
For all other application, please maintenance each 6 months at least

Customer _____

Address _____

Date Purchased _____

Controller Type _____

Time of Service Start: _____

End: _____

Distributor Name _____

Service Engineer _____

Battery Model _____

Battery SN. _____

● BATTERY CELL LOG

The cells information can be found on Lithium Golf gauge or blue tooth app, please record the cell information after 2 hours later charged the battery full

Cell NO.	Cell Voltage	Cell NO.	Cell Voltage	Cell NO.	Cell Voltage
1		9		17	
2		10		18	
3		11		19	
4		12		20	
5		13		21	
6		14		22	
7		15		23	
8		16		24	

Battery Volts: _____

● BATTERY CHECKLIST

YES NO Battery Tops Clean and Dry Comments: _____

YES NO Ensure Vent Caps are Clean Comments: _____

YES NO Battery Terminal Connections Tight Comments: _____

YES NO Battery temperature in normal range when charging the battery Comments: _____

Others: _____

● LITHIUM GOLF CHARGER

Charger Plug Pin stable and clean YES NO Comments: _____

Charger temperature in normal range when charging the battery YES NO Comments: _____

Signed by Service Engineer _____

Signed by Customer _____

Additional remarks _____

BATTERY MAINTENANCE LOG

Maintenance Requirements

For Personal golf, please maintenance annual at least
For all other application, please maintenance each 6 months at least

Customer _____

Address _____

Date Purchased _____

Controller Type _____

Time of Service Start: _____

End: _____

Distributor Name _____

Service Engineer _____

Battery Model _____

Battery SN. _____

● BATTERY CELL LOG

The cells information can be found on Lithium Golf gauge or blue tooth app, please record the cell information after 2 hours later charged the battery full

Cell NO.	Cell Voltage	Cell NO.	Cell Voltage	Cell NO.	Cell Voltage
1		9		17	
2		10		18	
3		11		19	
4		12		20	
5		13		21	
6		14		22	
7		15		23	
8		16		24	

Battery Volts: _____

● BATTERY CHECKLIST

YES NO Battery Tops Clean and Dry Comments: _____

YES NO Ensure Vent Caps are Clean Comments: _____

YES NO Battery Terminal Connections Tight Comments: _____

YES NO Battery temperature in normal range when charging the battery Comments: _____

Others: _____

● LITHIUM GOLF CHARGER

Charger Plug Pin stable and clean YES NO Comments: _____

Charger temperature in normal range when charging the battery YES NO Comments: _____

Signed by Service Engineer _____

Signed by Customer _____

Additional remarks _____

BATTERY MAINTENANCE LOG

Maintenance Requirements

For Personal golf, please maintenance annual at least
For all other application, please maintenance each 6 months at least

Customer _____

Address _____

Date Purchased _____

Controller Type _____

Time of Service Start: _____

End: _____

Distributor Name _____

Service Engineer _____

Battery Model _____

Battery SN. _____

● BATTERY CELL LOG

The cells information can be found on Lithium Golf gauge or blue tooth app, please record the cell information after 2 hours later charged the battery full

Cell NO.	Cell Voltage	Cell NO.	Cell Voltage	Cell NO.	Cell Voltage
1		9		17	
2		10		18	
3		11		19	
4		12		20	
5		13		21	
6		14		22	
7		15		23	
8		16		24	

Battery Volts: _____

● BATTERY CHECKLIST

YES NO Battery Tops Clean and Dry Comments: _____

YES NO Ensure Vent Caps are Clean Comments: _____

YES NO Battery Terminal Connections Tight Comments: _____

YES NO Battery temperature in normal range when charging the battery Comments: _____

Others: _____

● LITHIUM GOLF CHARGER

Charger Plug Pin stable and clean YES NO Comments: _____

Charger temperature in normal range when charging the battery YES NO Comments: _____

Signed by Service Engineer _____

Signed by Customer _____

Additional remarks _____

BATTERY MAINTENANCE LOG

Maintenance Requirements

For Personal golf, please maintenance annual at least
For all other application, please maintenance each 6 months at least

Customer _____

Address _____

Date Purchased _____

Controller Type _____

Time of Service Start: _____

End: _____

Distributor Name _____

Service Engineer _____

Battery Model _____

Battery SN. _____

● BATTERY CELL LOG

The cells information can be found on Lithium Golf gauge or blue tooth app, please record the cell information after 2 hours later charged the battery full

Cell NO.	Cell Voltage	Cell NO.	Cell Voltage	Cell NO.	Cell Voltage
1		9		17	
2		10		18	
3		11		19	
4		12		20	
5		13		21	
6		14		22	
7		15		23	
8		16		24	

Battery Volts: _____

● BATTERY CHECKLIST

YES NO Battery Tops Clean and Dry Comments: _____

YES NO Ensure Vent Caps are Clean Comments: _____

YES NO Battery Terminal Connections Tight Comments: _____

YES NO Battery temperature in normal range when charging the battery Comments: _____

Others: _____

● LITHIUM GOLF CHARGER

Charger Plug Pin stable and clean YES NO Comments: _____

Charger temperature in normal range when charging the battery YES NO Comments: _____

Signed by Service Engineer _____

Signed by Customer _____

Additional remarks _____

BATTERY MAINTENANCE LOG

Maintenance Requirements

For Personal golf, please maintenance annual at least
For all other application, please maintenance each 6 months at least

Customer _____

Address _____

Date Purchased _____

Controller Type _____

Time of Service

Start: _____

End: _____

Distributor Name _____

Service Engineer _____

Battery Model _____

Battery SN. _____

● BATTERY CELL LOG

The cells information can be found on Lithium Golf gauge or blue tooth app, please record the cell information after 2 hours later charged the battery full

Cell NO.	Cell Voltage	Cell NO.	Cell Voltage	Cell NO.	Cell Voltage
1		9		17	
2		10		18	
3		11		19	
4		12		20	
5		13		21	
6		14		22	
7		15		23	
8		16		24	

Battery Volts: _____

● BATTERY CHECKLIST

YES NO

Battery Tops Clean and Dry

Comments: _____

YES NO

Ensure Vent Caps are Clean

Comments: _____

YES NO

Battery Terminal Connections Tight

Comments: _____

YES NO

Battery temperature in normal range when charging the battery

Comments: _____

Others: _____

● LITHIUM GOLF CHARGER

Charger Plug Pin stable and clean

YES NO

Comments: _____

Charger temperature in normal range when charging the battery

YES NO

Comments: _____

Signed by Service Engineer _____

Signed by Customer _____

Additional remarks _____

BATTERY MAINTENANCE LOG

Maintenance Requirements

For Personal golf, please maintenance annual at least
For all other application, please maintenance each 6 months at least

Customer _____

Address _____

Date Purchased _____

Controller Type _____

Time of Service Start: _____

End: _____

Distributor Name _____

Service Engineer _____

Battery Model _____

Battery SN. _____

● BATTERY CELL LOG

The cells information can be found on Lithium Golf gauge or blue tooth app, please record the cell information after 2 hours later charged the battery full

Cell NO.	Cell Voltage	Cell NO.	Cell Voltage	Cell NO.	Cell Voltage
1		9		17	
2		10		18	
3		11		19	
4		12		20	
5		13		21	
6		14		22	
7		15		23	
8		16		24	

Battery Volts: _____

● BATTERY CHECKLIST

YES NO Battery Tops Clean and Dry Comments: _____

YES NO Ensure Vent Caps are Clean Comments: _____

YES NO Battery Terminal Connections Tight Comments: _____

YES NO Battery temperature in normal range when charging the battery Comments: _____

Others: _____

● LITHIUM GOLF CHARGER

Charger Plug Pin stable and clean YES NO Comments: _____

Charger temperature in normal range when charging the battery YES NO Comments: _____

Signed by Service Engineer _____

Signed by Customer _____

Additional remarks _____

BATTERY MAINTENANCE LOG

Maintenance Requirements

For Personal golf, please maintenance annual at least
For all other application, please maintenance each 6 months at least

Customer _____

Address _____

Date Purchased _____

Controller Type _____

Time of Service Start: _____

End: _____

Distributor Name _____

Service Engineer _____

Battery Model _____

Battery SN. _____

● BATTERY CELL LOG

The cells information can be found on Lithium Golf gauge or blue tooth app, please record the cell information after 2 hours later charged the battery full

Cell NO.	Cell Voltage	Cell NO.	Cell Voltage	Cell NO.	Cell Voltage
1		9		17	
2		10		18	
3		11		19	
4		12		20	
5		13		21	
6		14		22	
7		15		23	
8		16		24	

Battery Volts: _____

● BATTERY CHECKLIST

YES NO Battery Tops Clean and Dry Comments: _____

YES NO Ensure Vent Caps are Clean Comments: _____

YES NO Battery Terminal Connections Tight Comments: _____

YES NO Battery temperature in normal range when charging the battery Comments: _____

Others: _____

● LITHIUM GOLF CHARGER

Charger Plug Pin stable and clean YES NO Comments: _____

Charger temperature in normal range when charging the battery YES NO Comments: _____

Signed by Service Engineer _____

Signed by Customer _____

Additional remarks _____

THE FUTURE IS NOW



Lithium Golf
AUSTRALIA

UP TO*

YEAR
5
WARRANTY

UP TO

10 YRS**
DESIGN
LIFESPAN



lithiumgolf.com.au